

SK-150M SK-160M SK-170M SK-180M

Representation	Product name	Solar cell number	Solar Cell Type	Wattage	Silicon Type
EXAMPLE	SK-M	36 PCS	156 x 156mm	150W	M:Monocrystalline



Features

- Tempered and high transparent low-iron glass**
directs more light on the solar cells, resulting in a higher energy yield.
- Excellent low-light performance**
produces energy even at low light levels, especially in the morning, evening and winter season.
- Special and advanced module sealing technology**
to avoid leakage and frame deformation.
- Well-suited module size**
for almost all PV applications.
- Durable PV modules**
can be used for harsh environmental conditions, such as exposure to salt mist, and known potential induced degradation risk factors.



Warning: Read the Installation and User Manual in its entirety before handling, installing, and operation smart Solar modules.

Module Warranty

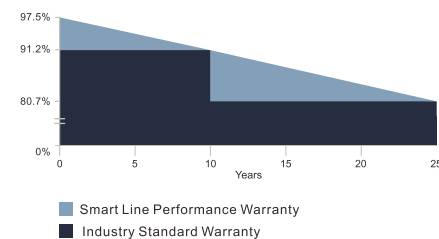

25-year limited warranty of 80% power output;
10-year limited warranty of 90% power output;
5-year limited warranty of materials and workmanships.

Note: This publication summarizes product warranty and Specifications which are subject to change without notice

SK-150M SK-160M SK-170M SK-180M

ELECTRICAL PERFORMANCE

Electrical parameters at Standard Test Conditions(STC)						
Module type			SK-150M	SK-160M	SK-170M	SK-180M
Power output	P_{max}	W	150	160	170	180
Power output tolerances	ΔP_{max}	W	0/+5			
Module efficiency	η_m	%	17.6	17.7	17.8	17.9
Voltage at P max	V_{mp}	V	18.09	18.05	18.05	18.04
Current at P max	I_{mp}	A	8.29	8.86	9.42	9.98
Open-circuit voltage	V_{oc}	V	22.25	22.03	22.03	21.82
Short-circuit current	I_{sc}	A	8.87	9.48	10.08	10.68

STC:1000W/m² irradiance, 25°C module temperature, AM1.5g spectrum according to EN60904-3. Average relative efficiency reduction of 3.3% at 200W/m² according to EN 60904-1.

Thermal Characteristics			
Nominal operating cell temperature	NOCT	°C	46+/-2
Temperature coefficient of P_{max}	γ	%/°C	-0.42
Temperature coefficient of V_{oc}	β_{Voc}	%/°C	-0.32
Temperature coefficient of I_{sc}	α_{Isc}	%/°C	0.05
Temperature coefficient of V_{mpp}	β_{Vmpp}	%/°C	-0.42

Operating Conditions	
Max.system voltage	1000VDC
Max.series fuse rating	15A
Limiting reverse current	15A
Operating temperature range	-40°C to 85°C
Max.static load, front(e.g., snow)	5400Pa
Max.static load, back(e.g., wind)	2400Pa
Max.hailstone impact(diameter/velocity)	25mm/23m/s

Construction Materials	
Front cover(material/thickness)	low-iron tempered glass/4.0mm
Cell(quantity/material/dimensions /number of busbars)	36/ multicrystalline silicon /156mm×156mm 4 or 5
Frame(material/color/anodization color/edge sealing)	anodized aluminum alloy/silver/clear /silicone or tape
Junction box(protection degree)	≥IP65
Cable(length/cross-sectional area)	1100mm/4mm ²
Plug connector(type/protection degree)	MC4/IP67 or YT08-1/IP67 or Amphenol H4/IP68
Dimensions(L/W/H)	1480mm/680mm/40mm
Weight	11.05kg

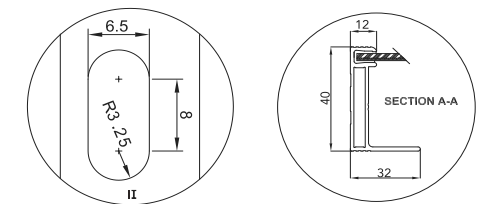
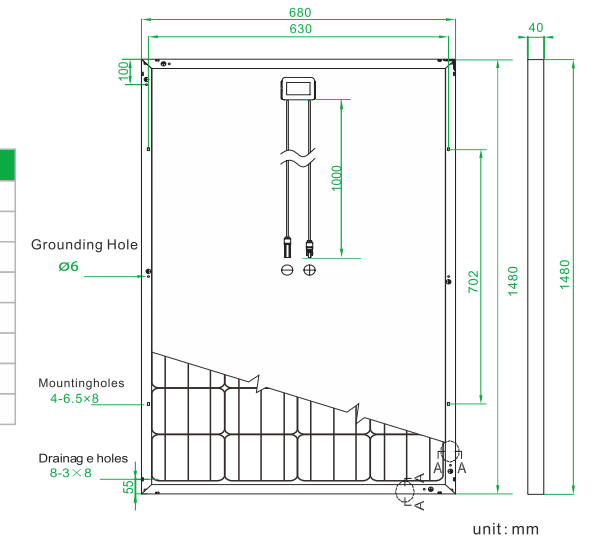

Module Diagram

